

CROSS REFERENCES	
SHEET NO.	DESCRIPTION
3	☉ References & Benchmarks
38	Culvert Details

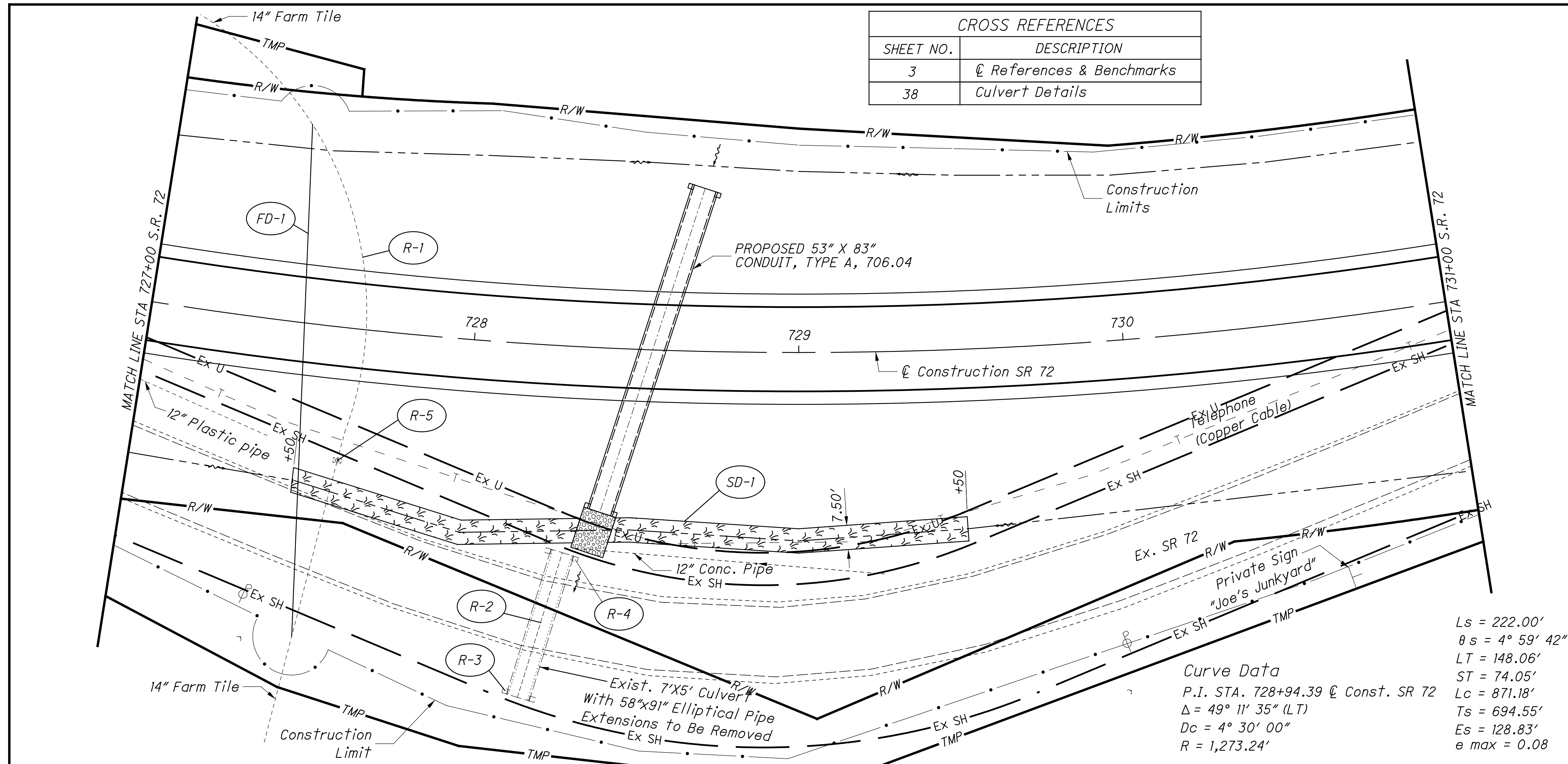

Curve Data
 P.I. STA. 728+94.39 ☉ Const. SR 72
 $\Delta = 49^\circ 11' 35''$ (LT)
 $D_c = 4^\circ 30' 00''$
 $R = 1,273.24'$
 $L_s = 222.00'$
 $\theta_s = 4^\circ 59' 42''$
 $LT = 148.06'$
 $ST = 74.05'$
 $L_c = 871.18'$
 $T_s = 694.55'$
 $E_s = 128.83'$
 $e_{max} = 0.08$

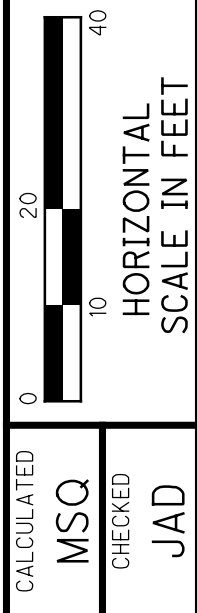
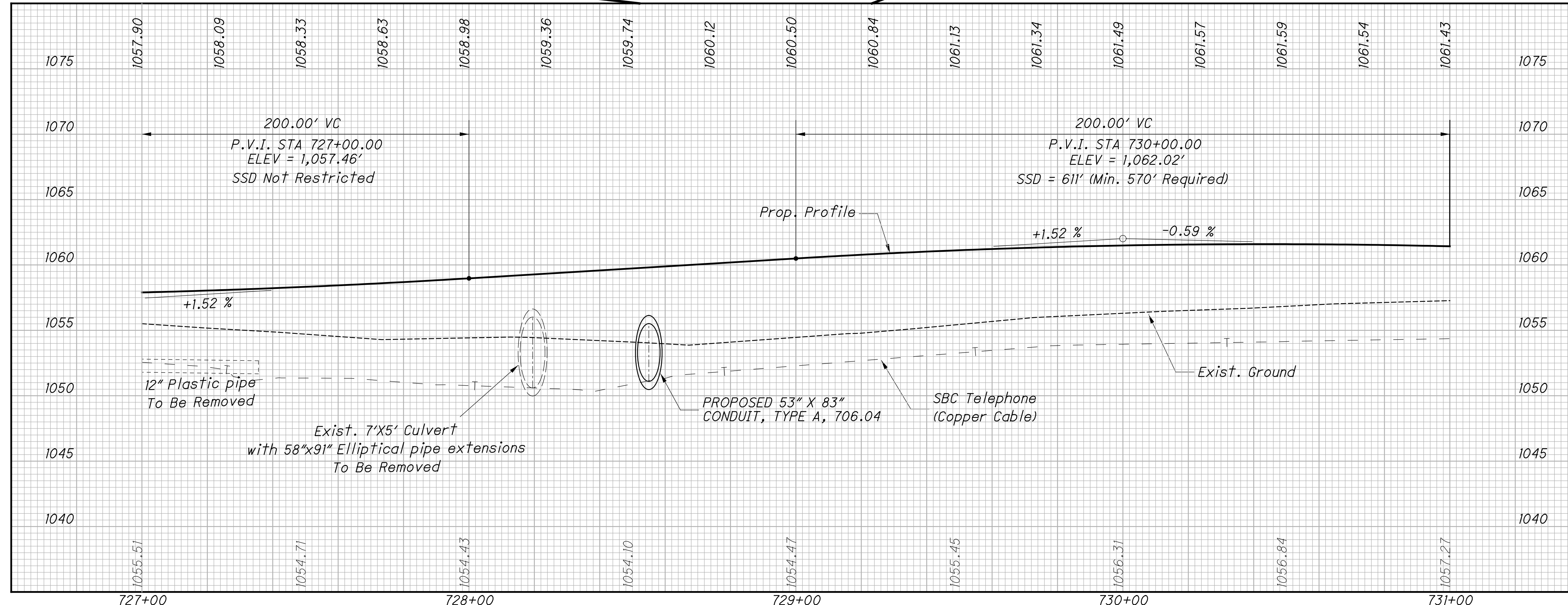

REF NO.	STATION		SIDE	DESCRIPTION	QTY	UNIT	TOTAL
	FROM	TO					
R-1	727+43	727+56	RT & LT	EROSION CONTROL MAT, TYPE A	167	SY	167
R-2	728+15	728+22	RT	15\"/>			
R-3	728+17	728+23	RT	REMOVAL MISC.: 2\"/>			
R-4	728+27	728+35	RT	REMOVAL MISC.: 7\"/>			
R-5	728+51	728+53	RT	REMOVAL MISC.: 7\"/>			
FD-1	727+43	727+56	RT & LT	PIPE REMOVED, 24\"/>			
SD-1	727+50	729+50	RT	HEADWALL REMOVED	2	EACH	2
TOTALS CARRIED TO GENERAL SUMMARY							